

KITPLANES FOR AFRICA

www.saplanes.co.za

P.O.Box 326

KOMATIPOORT

1340

South Africa

Rick Burrough 082 410032

Stefan Coetzee 082 6018970

info@saplanes.co.za

SERVICE BULLETIN

AIRCRAFT EFFECTED: All models

BULLETIN NUMBER: SB008

ORIGINAL ISSUE DATE: 04-04-02

REVISION DATE: 16-11-08

SUBJECT: Fuel cap vents

APPLICABILITY: All KFA aircraft

COMPLIANCE: Mandatory

Problem: Fuel cap vents rotating backwards in flight.
This will cause a small vacuum in the fuel tank and may compromise gravity fuel feed and even lead to some fuel discharge through the vent in flight.

Solution: Fuel cap vents should be correctly fitted in accordance with the build manual by threading the lower part of the vent and fitting a check nut on the top and a nut on the inside, compressing a cork washer.
Lightly tighten the nuts until the vent will not rotate easily but can still be rotated to face front when required with the fuel cap turned on tightly.

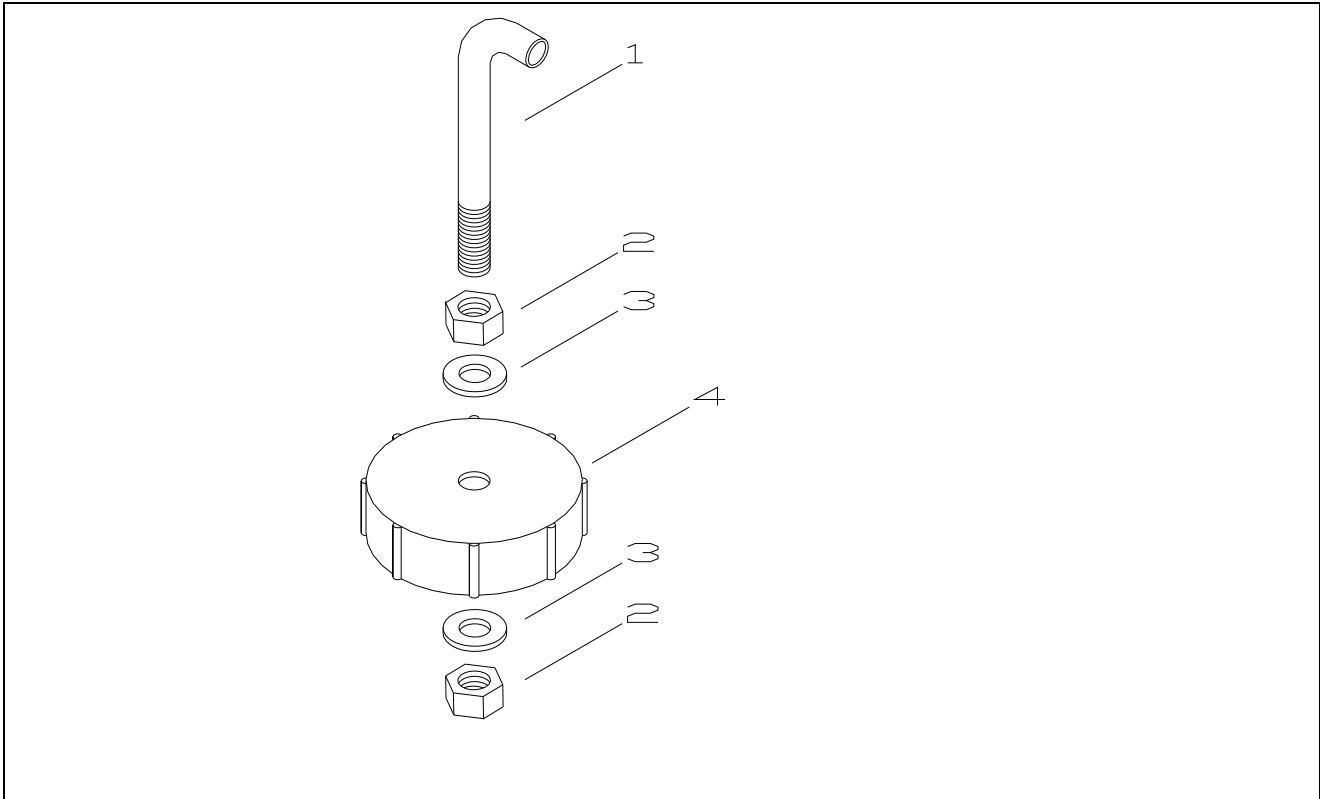

| Fig # | Part # | Part description | Qty/assey | Notes |
|-------|--------|------------------|-----------|-------------------------|
| 1 | | Vent, fuel tank | 1 | Owner to thread |
| 2 | N010 | Nut M10 | 2 | Loctite nuts |
| 3 | W010 | Washer m10 | 2 | Fit cork washer between |
| 4 | WT-2 | Cap, fuel tank | 1 | |